

AuroRa® Installation Guide

(Please leave installation guide with resident homeowner)

The AuroRa installation guide is designed to help you plan and complete the installation of your AuroRa Lighting Control System.

Refer to the information included in this guide to learn about the following:

- AuroRa lighting control package contents
- How to install AuroRa dimmers
- How to operate your system

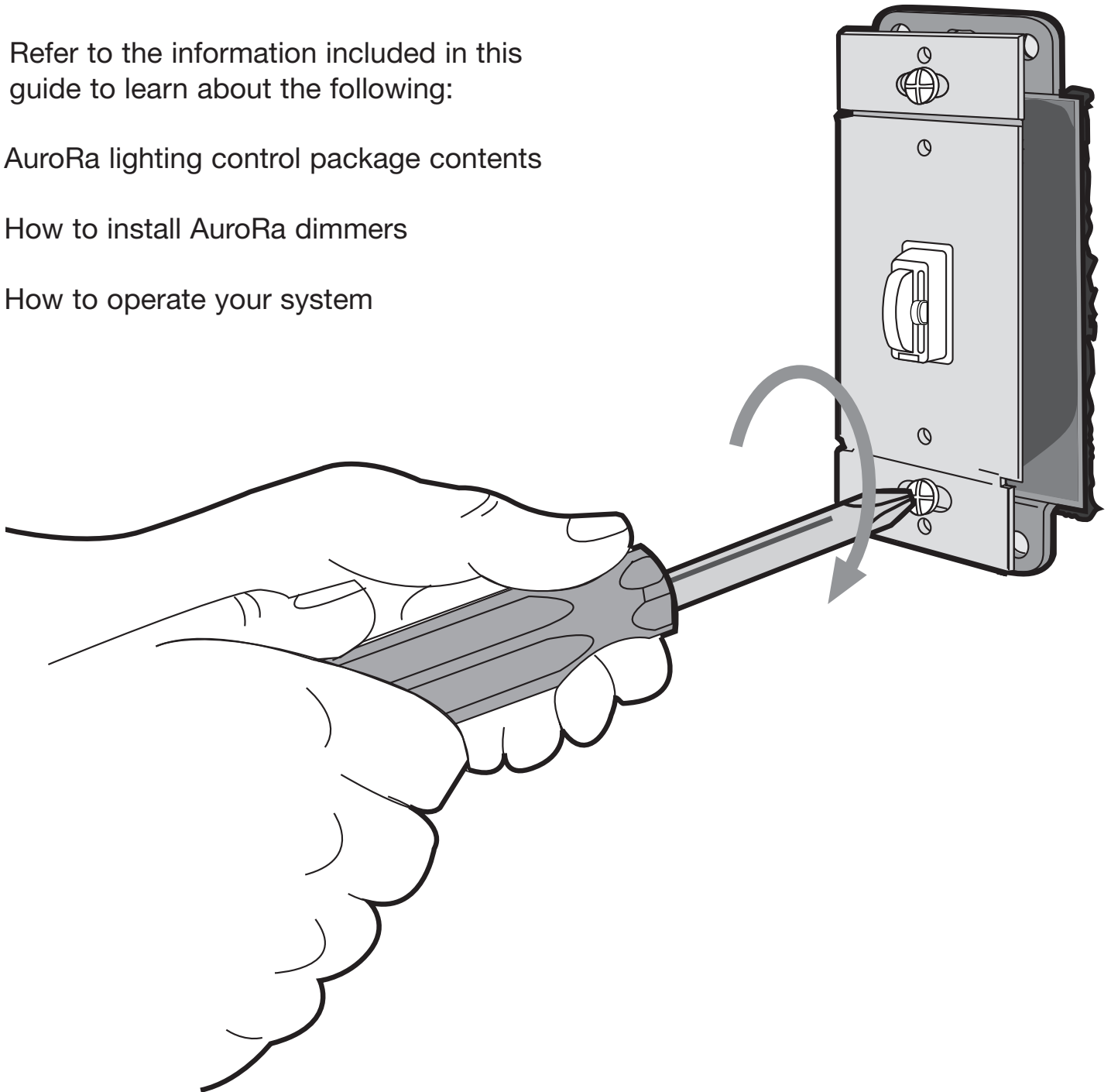

Consumer Information:

This lighting control system must not be used to control equipment other than lighting. It must not be used to control equipment which could create hazardous situations, such as entrapment, if operated accidentally. Examples of equipment which must not be controlled by this system include (but are not limited to) motorized gates, garage doors, industrial doors, microwave ovens, heating pads, etc. It is the installer's responsibility to ensure that only lighting is connected to this system.

Table of Contents

Installing your system is simple. We recommend you read through all the instructions before starting.

Choose from the topics below to help guide you through the process.

Before You Begin	2
Selecting Your Dimmer Location	3
Installing Your Dimmers	4
Replacing Switches With Dimmers	5
Setting Up Your Master Control	12
Setting Up Your Central Antenna	13
Enjoying Your System	14
Adding to Your System	
- bridging two systems	15
- activating additional wireless controllers	16
Frequently Asked Questions	17
General Information	18
Troubleshooting	19

If you have any questions, the Lutron Technical Support Hotline is ready to help 24 hours, 7 days a week. Call us at 800.523.9466 for immediate assistance. Or, find information on the internet at www.lutron.com/aurora.

Before You Begin

What's in your new system

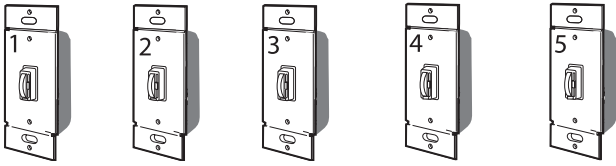

dimmers
(5)

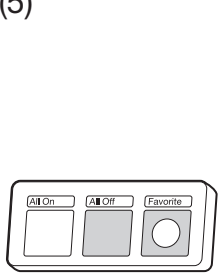

wireless controller
(1)

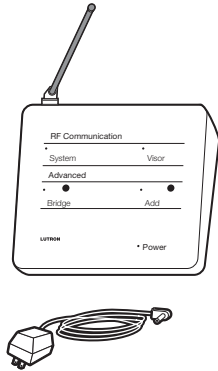

central antenna and
dc adapter (1)

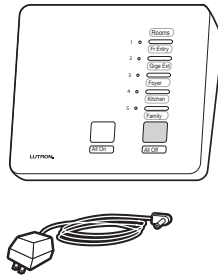

master control
and dc adapter
(1)

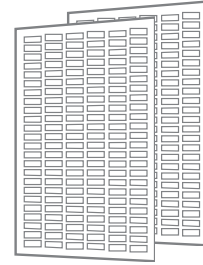

label sheets
(2)

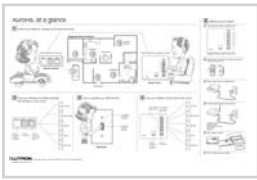

"at a glance"
sheet
(1)

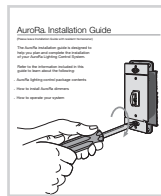

instruction
booklet
(1)

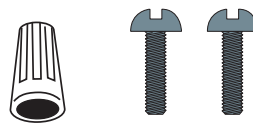

wire nut and
screw kit
(5)



small
screwdriver
(1)

Tools you may need

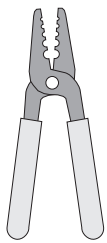

wire
stripper

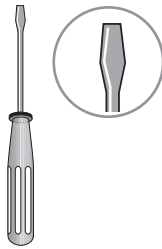

slotted
screwdriver

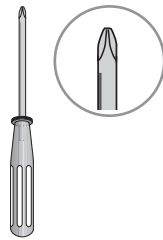

phillips
screwdriver



wire
cutter



electrical tape



flashlight

Selecting Your Dimmer Location

① Decide which lights you want to control with dimmers

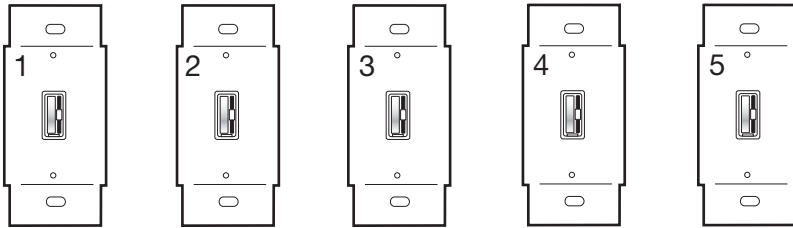

Helpful Hint: Dimmer 1 should control your most used light. Dimmer 2 should control your second most used light. Repeat for dimmers 3, 4, and 5.

Choose Your Locations:

Dimmer 1: _____

Dimmer 2: _____

Dimmer 3: _____

Dimmer 4: _____

Dimmer 5: _____

Suggested Locations:
 Dimmer 1: **Front Entry**
 Dimmer 2: **Garage Exterior**
 Dimmer 3: **Hall/Foyer**
 Dimmer 4: **Kitchen**
 Dimmer 5: **Family Room**

Personalize your system

② Label your master control with your light locations

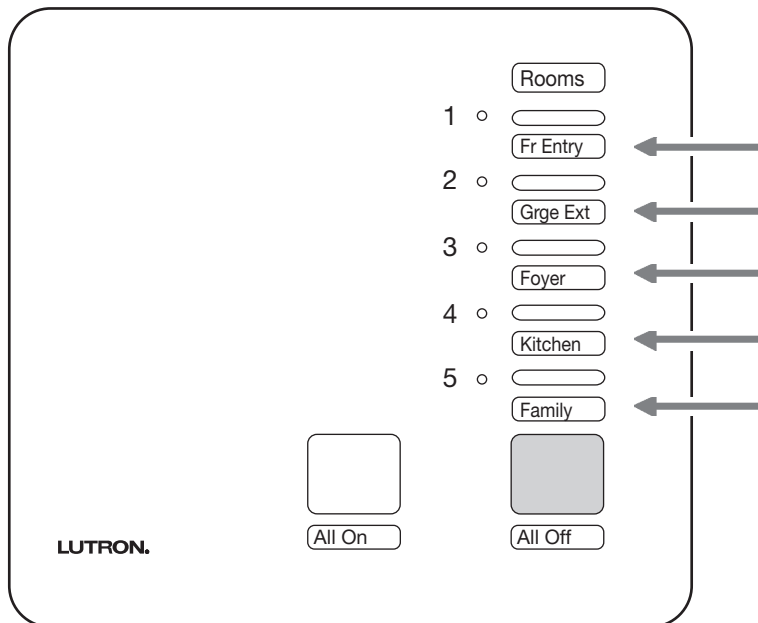

Helpful Hint: Use the included labels.

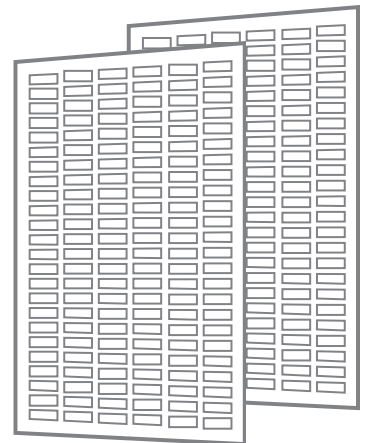

(Suggested locations shown)

Installing Your Dimmers

Installing an AuroRa dimmer is as straightforward as replacing a light switch.

Your first step is to identify how many switches control the lights you have decided to add to your system.

This is important so that you use the correct installation instructions.

Lutron has created specific instructions for lights controlled by one, two, or three switches to help simplify your installation.

After you have installed the first dimmer, repeat the process until all of the AuroRa dimmers have been installed.

Note:

If this is your first time wiring a dimmer, we recommend that you read over the dimmer information found on page 18 before proceeding. If you have any questions, give our 24/7 Technical Support Center a call at 800.523.9466.

Use dimmers with 120V incandescent lighting fixtures only. Do not use with low-voltage transformers.

The total wattage of all light bulbs controlled by each dimmer must be between 50 and 600 watts.

When combining dimmers in the same wallbox, the dimmer's load capacity must be reduced.

Replacing Switches With Dimmers

- 1 Write down how many switches control the lights you selected as 1-5 on your Master Control

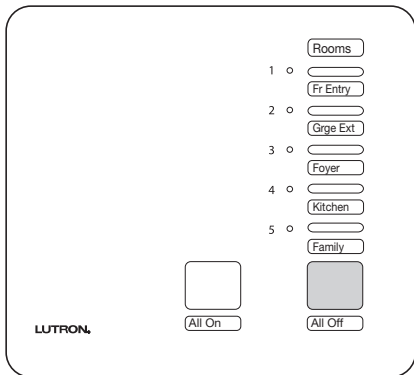

Your Locations:

Number of Switches:

1: _____
 2: _____
 3: _____
 4: _____
 5: _____

- A For lights controlled by one switch, use instructions on page 6 and 7



Helpful Hint:
 This circuit is called a single-pole circuit.

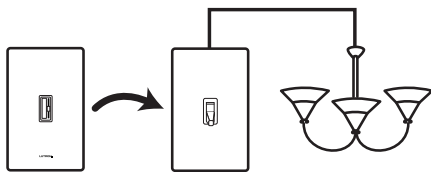

- Typical location:
- Porch light
 - Bedroom light

- B For lights controlled by two switches, use instructions on page 8 and 9



Helpful Hint:
 This circuit is called a three-way circuit.

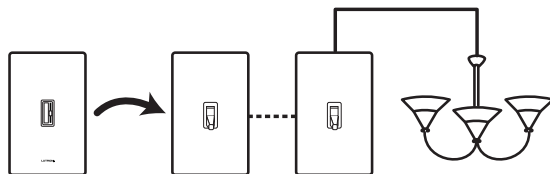

- Typical location:
- Hallway light
 - Kitchen light

- C For lights controlled by three switches, use instructions on page 10 and 11



Helpful Hint:
 This circuit is called a four-way circuit.

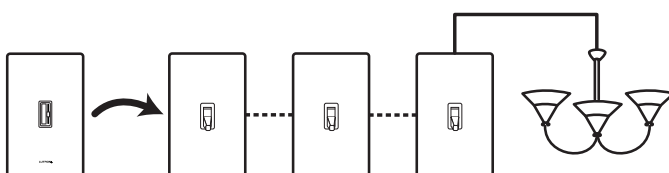

- Typical location:
- Stairwell light

Installing A Dimmer For Lights Controlled By One Switch

- ① Turn power off at circuit breaker or remove fuse

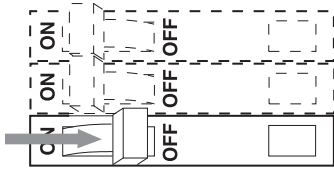

WARNING: Power must be turned off for your safety.

- ② Remove wallplate

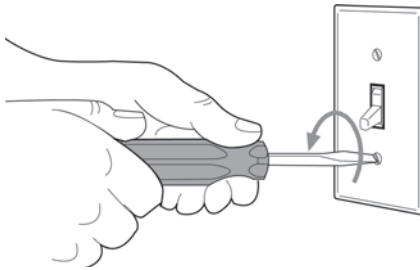

Helpful Hint: Save your wallplate and screws.

- ③ Remove existing switch

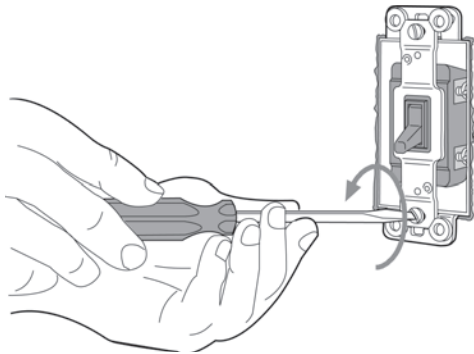

- ④ Uninstall switch



Helpful Hint: Use the Lutron screwdriver (supplied) to help remove “pushed-in” wires on existing switch.

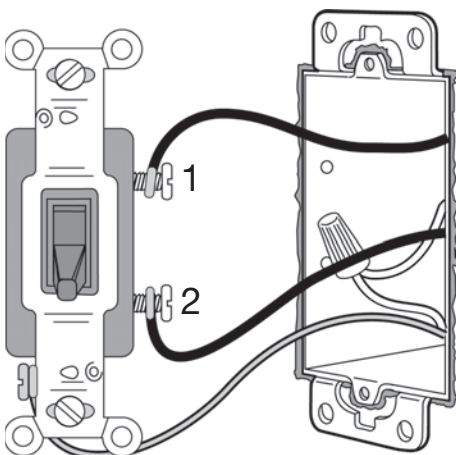

A. You should see two insulated wires attached to the switch. A green or bare wire is a ground wire.

B. Disconnect the wires from the switch.

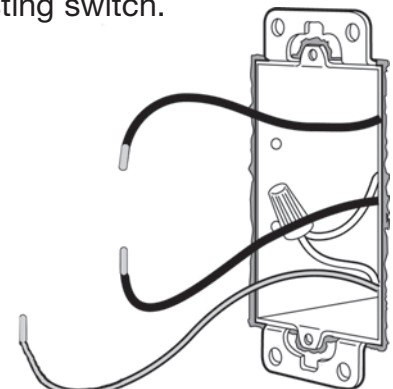

⑤ Install dimmer

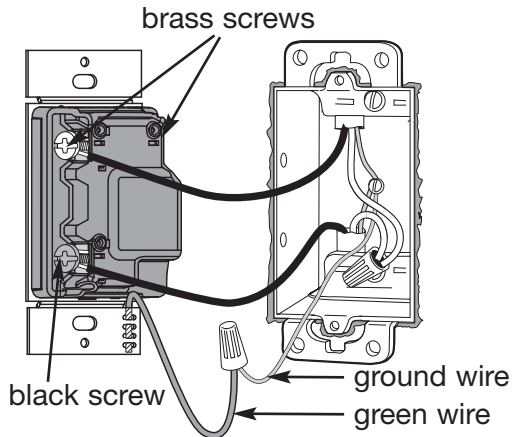

A. Connect the green or bare wire (ground wire) to the green wire on the dimmer with a wire nut.



B. Connect one wire to the black screw on the dimmer.

C. Connect the other wire to one of the two gold colored screws (brass) on the dimmer.

⑥ Mount dimmer

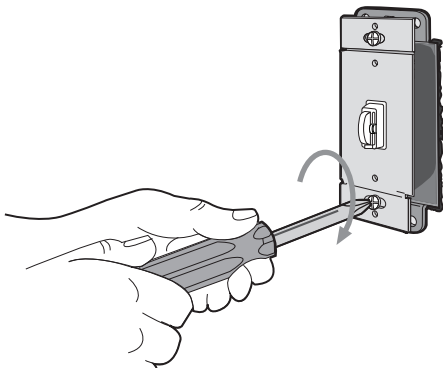

⑦ Replace wallplate

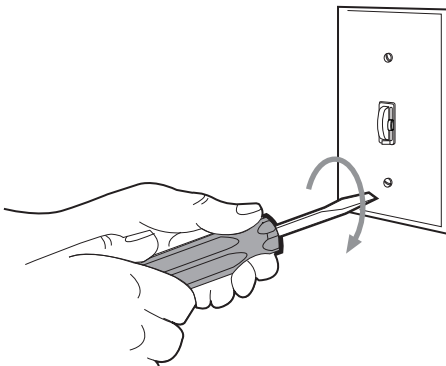

⑧ Turn power on at circuit breaker or replace fuse

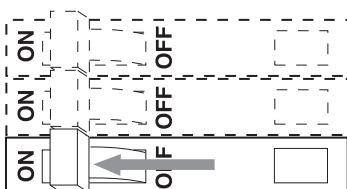

Installing A Dimmer For Lights Controlled By Two Switches

- ① Turn power off at circuit breaker or remove fuse

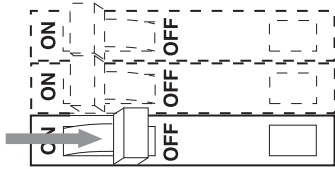

WARNING: Power must be turned off for your safety.

- ② Remove wallplate

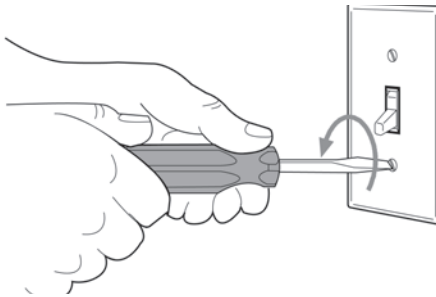

Helpful Hint: Save your wallplate and screws.

- ③ Remove existing switch from wall (Do not disconnect wires yet)

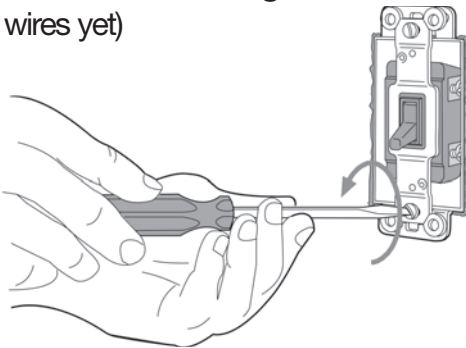

Reminder: Only replace one of the two switches controlling the light with a dimmer.

- ④ Uninstall switch

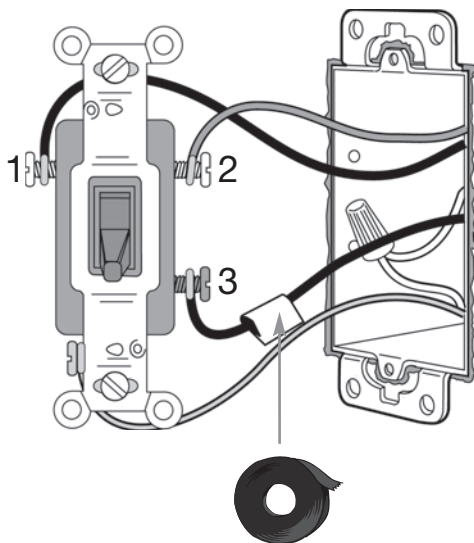

Helpful Hint:

Use the Lutron screwdriver (supplied) to help remove “pushed-in” wires on existing switch.

A. You should see three insulated wires attached to the switch. A green or bare wire is a ground wire.

B. Tag the wire attached to the different colored screw. This screw is usually labeled COMMON.

C. Disconnect the wires from the switch.

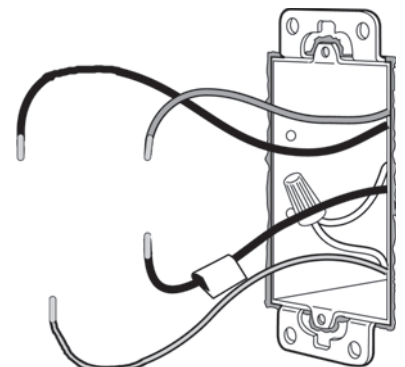

5 Install dimmer

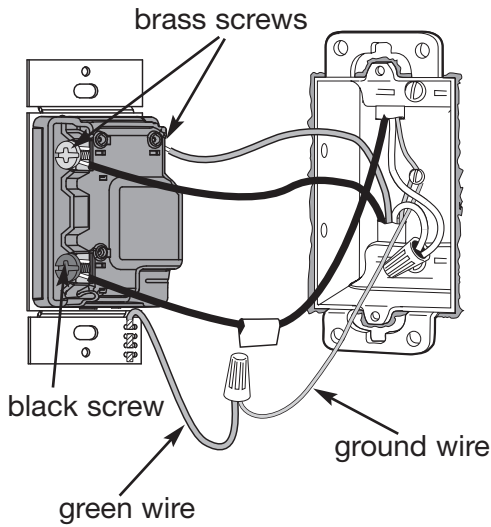

A. Connect the green or bare wire (ground wire) to the green wire on the dimmer with a wire nut.



B. Connect the tagged wire to the black colored screw on the dimmer.

C. Connect one of the remaining wires to either of the gold colored screws (brass) on the dimmer.

D. Connect the remaining wire to the remaining gold colored screw (brass) on the dimmer.

6 Mount dimmer

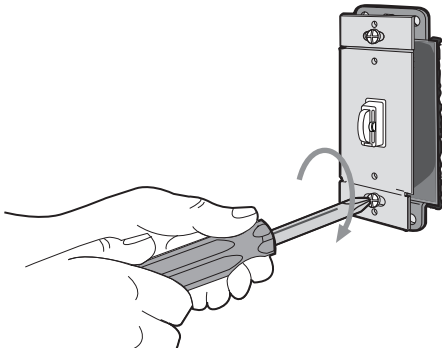

7 Replace wallplate

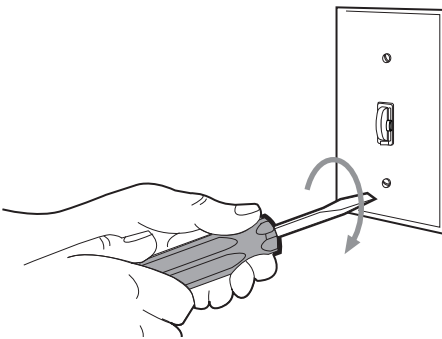

8 Turn power on at circuit breaker or replace fuse

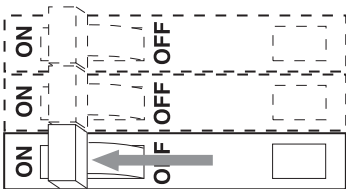

Installing A Dimmer For Lights Controlled By Three Switches

- ① Turn power off at circuit breaker or remove fuse

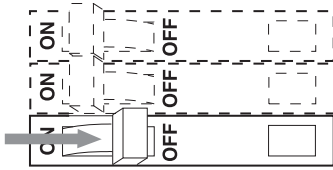

WARNING: Power must be turned off for your safety.

- ② Remove wallplate

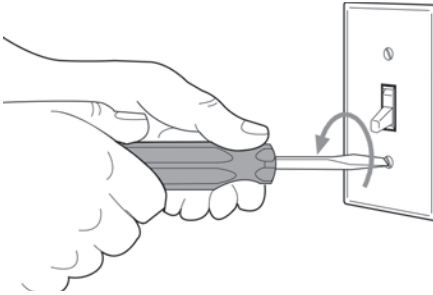

Helpful Hint: Save your wallplate and screws.

- ③ Remove existing switch from wall (Do not disconnect wires yet)

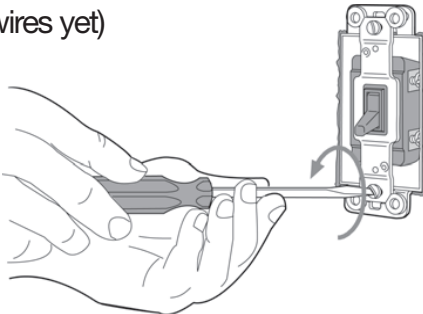

Reminder: Only replace one of the three switches controlling the light with a dimmer.

- ④ Locate a switch with three insulated wires attached to it

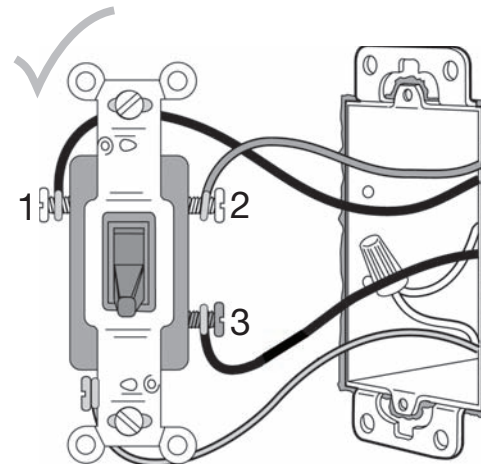
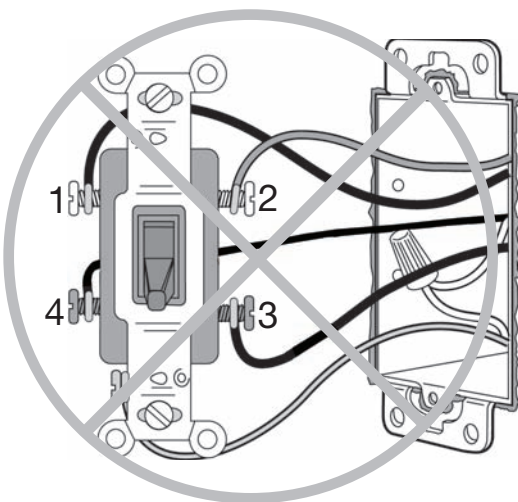

Note: If the switch has four wires attached to it, remount it and remove one of the other two switches. The AuroRa dimmer cannot be used in a switch location that has four wires.

5 Uninstall switch

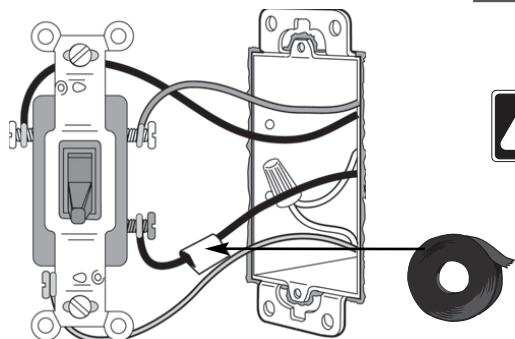

Helpful Hint:

Use the Lutron screwdriver (supplied) to help remove “pushed-in” wires on existing switch.



A. Tag the wire attached to the different colored screw. This screw is usually labeled COMMON.

B. Disconnect the wires from the switch.

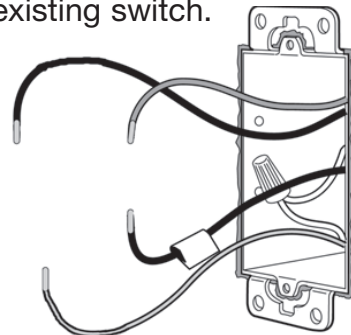

6 Install dimmer

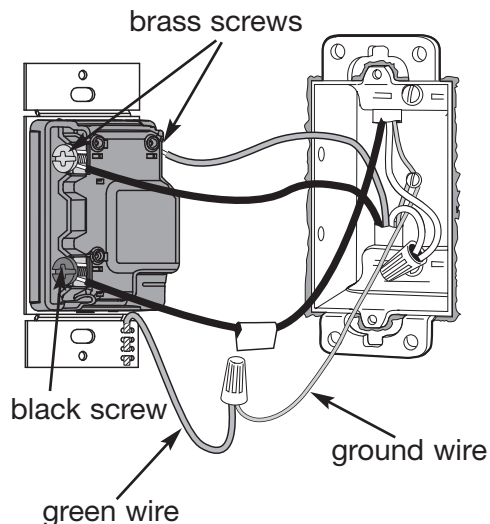

A. Connect the green or bare wire (ground wire) to the green wire on the dimmer with a wire nut.



B. Connect the tagged wire to the black colored screw on the dimmer.

C. Connect one of the remaining wires to either of the gold colored screws (brass) on the dimmer.

D. Connect the remaining wire to the remaining gold colored screw (brass) on the dimmer.

7 Mount dimmer and replace wallplate

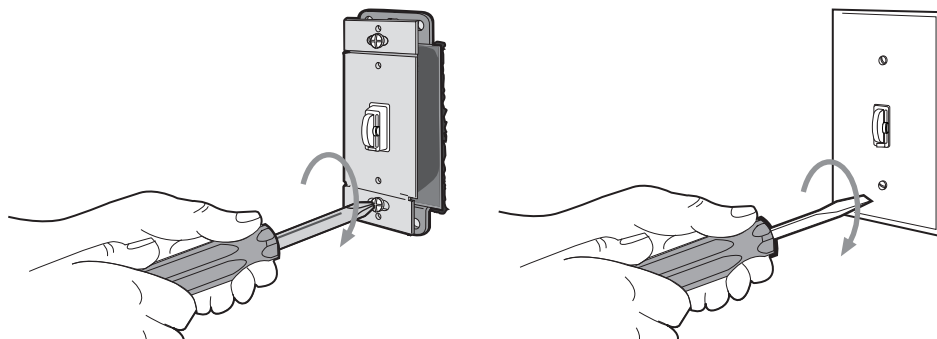

8 Turn power on at circuit breaker or replace fuse

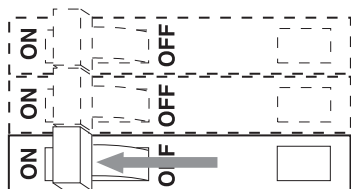

Setting Up Your Master Control

- 1 Select a location and plug in master control

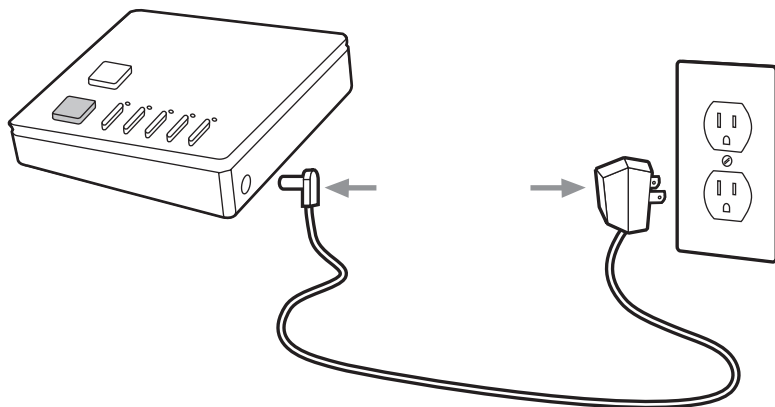

Helpful Hint: Place the master control where you will want to control lights throughout your home.

Suggested locations:

- Bedside table
- Kitchen counter

- 2 Remove the 1, 2, 3, 4, 5 label

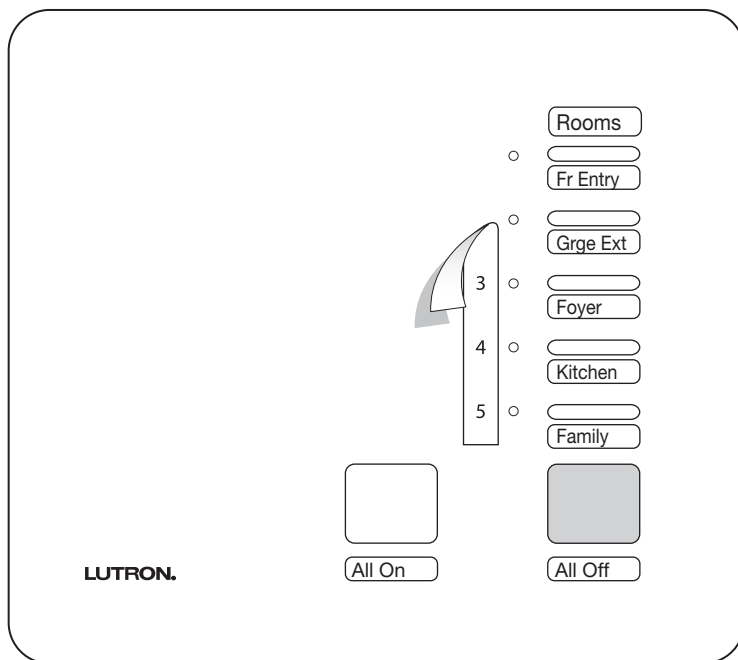

Setting Up Your Central Antenna

① Find the approximate center of your system

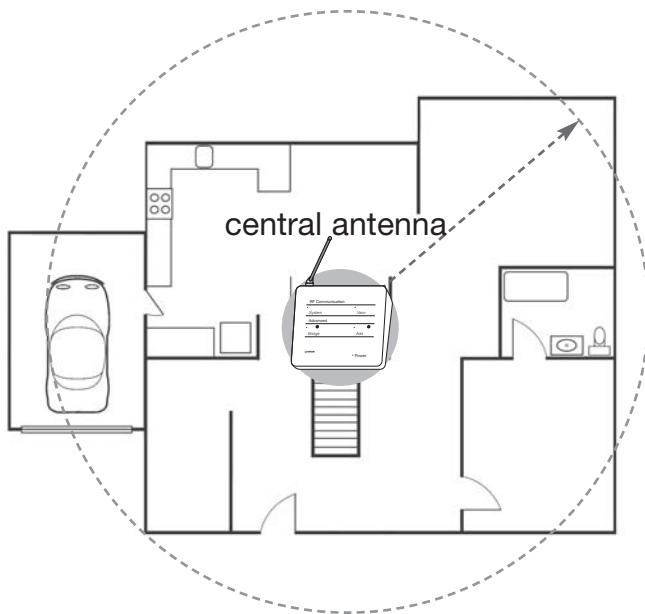

Helpful Hint: the central antenna works best within 30 feet of your master control and dimmers.

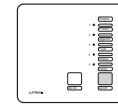

master control

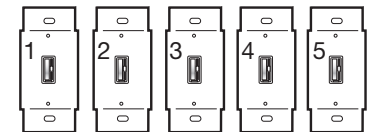

dimmers

② Plug in your central antenna

The Central Antenna plugs in to a standard wall outlet and should be placed centrally in the home to ensure the best Radio Frequency coverage.

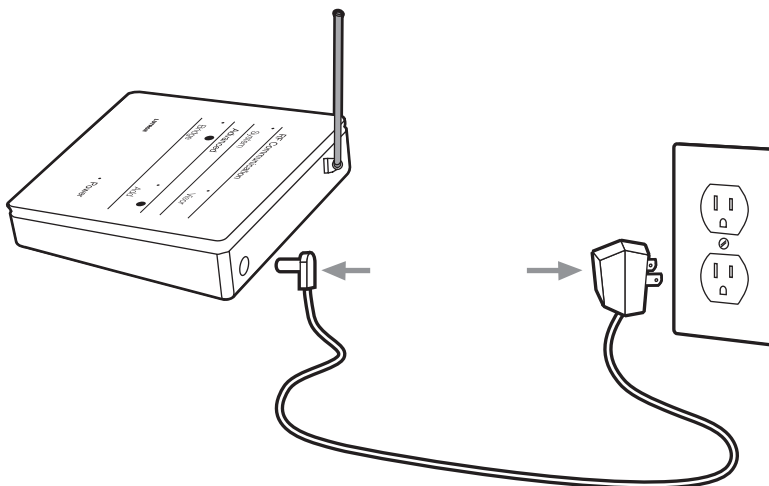

Helpful Hint: Don't place your central antenna inside a metal container. The metal container will block radio signals and keep the central antenna from working properly.

The central antenna does not need to be placed in the open. We recommend placing it in a discrete location that is out of sight.

Suggested locations:

- Under a sofa
- Under a table
- In a closet
- In a cabinet above microwave

Enjoying Your System

① Monitor and control lights throughout your home from one place

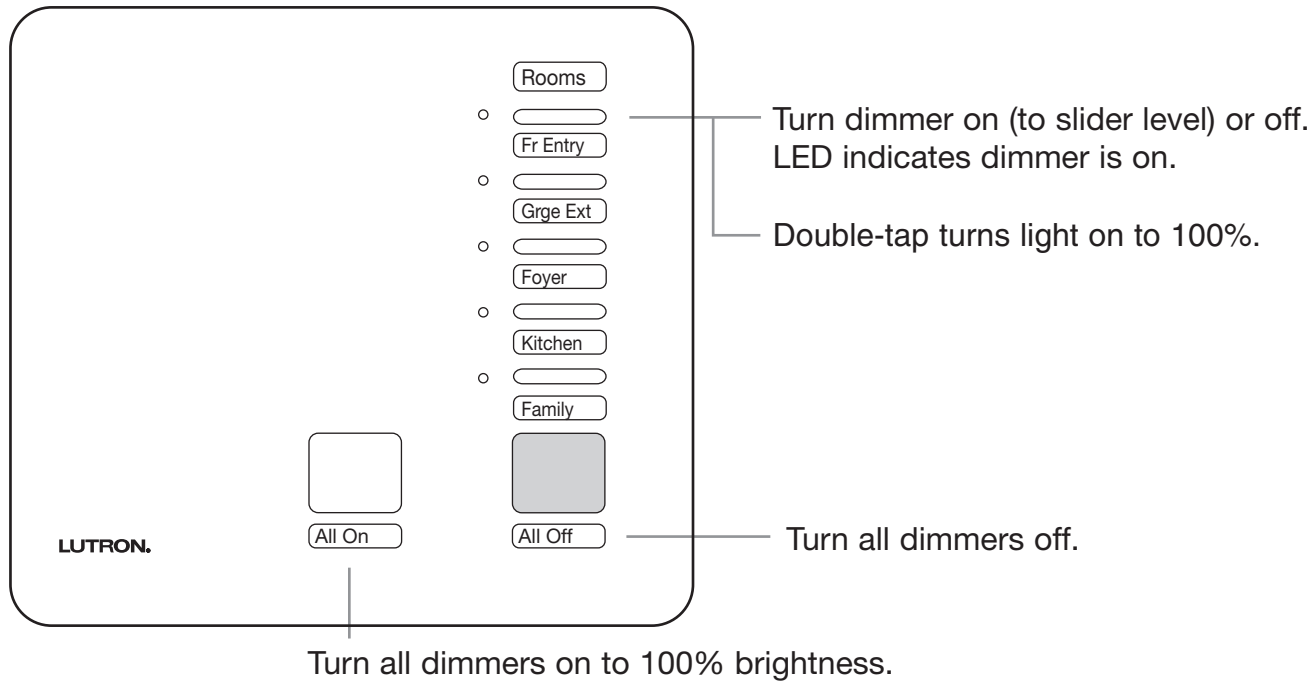

② Have your lights welcome you home

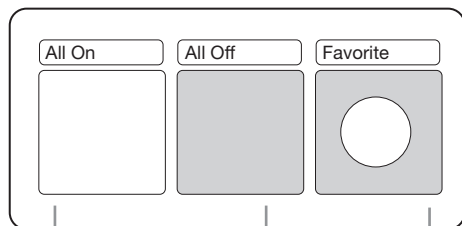

Turn all dimmers on to 100% brightness. Turn all dimmers off. Turn all dimmers on to the slider levels.

③ Dim to transform the look of any room

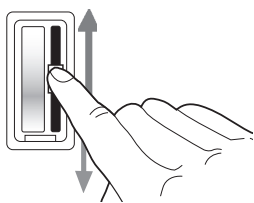

Slide to adjust light level.

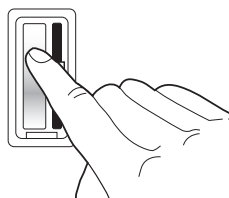

Tap to turn lights on and off.

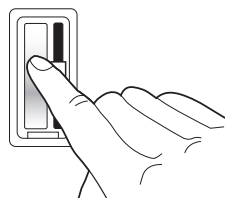

Double-tap button turns lights on to 100%.
Hold button for 1-2 seconds to start 10 second fade to off.



Service Switch: Pull service switch out to open position to replace light bulbs. Push service switch in after new bulb is installed.

Adding to Your System

Bridging AuroRa® Systems

- 1 Purchase and install two separate AuroRa systems.
- 2 To bridge two systems, press and hold the “Bridge” button on the central antenna of either system for 3 seconds. The “Bridge” LED should flash slowly.
- 3 Press and hold the “Bridge” button on the second central antenna for 3 seconds. The “Bridge” LED should flash slowly.
The LEDs on both central antennas will begin to flash quickly as the bridging process starts.
The loads in both systems will start flashing.
- 4 When the process is finished, the “Bridge” LEDs on both central antennas will stop flashing and stay on. The loads in both systems will stop flashing.
- 5 The systems are now bridged.

? For information about returning your system to its original default settings, visit www.lutron.com/aurora.

The central antennas should be at least 3 feet apart and within 60 feet of each other when bridging two systems.

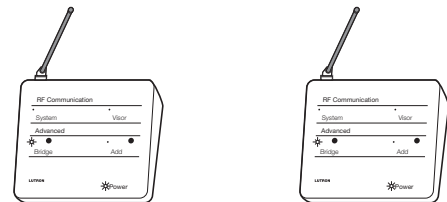
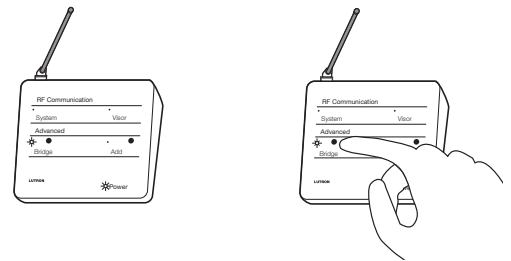
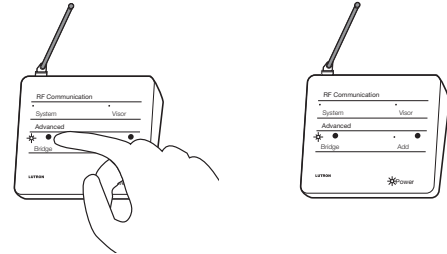

Bridged System Functionality

“All On” Button

All dimmers in both systems will turn on to full brightness.

“All Off” Button

All dimmers in both systems will turn off.

“Favorite” Button

All dimmers in both systems will turn on to their local slider levels.

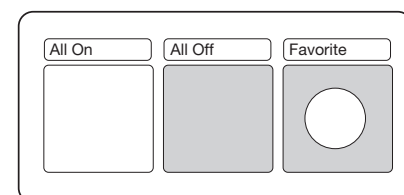
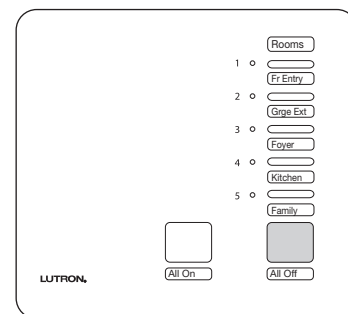

Adding to Your System

Activating Additional Wireless Controllers

Before additional wireless controllers can be used to control lights in the AuroRa® system, they must be activated. Follow the steps below to activate a wireless controller.

- 1 Enter Advanced “Add” Mode**
Press and hold the “Add” button on the central antenna until the LED light begins to flash (approximately 3 seconds).

Dimmers that are in the system will flash the lights connected to each. The master control will flash the LEDs corresponding to dimmers present in the system.

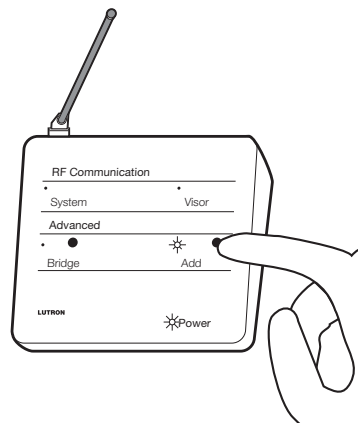

- 2 Activate Wireless Controller**
Press and hold any button on the wireless controller until the “Visor” LED light on the central antenna starts flashing (approximately three seconds), indicating the wireless controller has been activated in the system. The “Add” LED and the “Visor” LED will remain flashing until the wireless controller button is released.

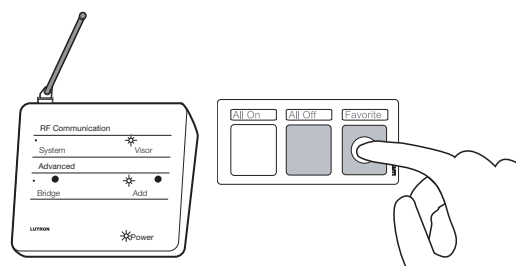

- 3 Exit Advanced “Add” Mode**
Press and hold the “Add” button until the “Add” LED light stops flashing and remains off (approximately 3 seconds).

The dimmers will stop flashing their lights.

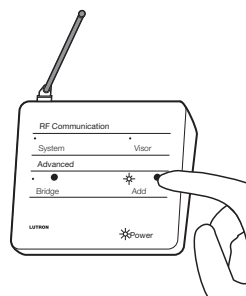

- 4 The wireless controller has now been activated.**

Frequently Asked Questions

How far away can I use my wireless controller?

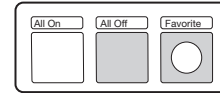
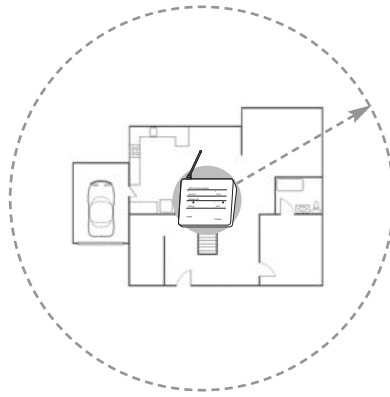

100 feet typically in any direction from the central antenna

What is the range of the central antenna?

The central antenna has a radio frequency range of at least 30 feet in any direction.

Will other equipment in my home or neighboring homes interfere with my AuroRa® system?

AuroRa® operates at a frequency different from most remote controls, cellular/portable phones, and other wireless devices. The communication protocol ensures that any device operating at the same frequency will not affect your system.

What happens to the AuroRa system during a power outage?

AuroRa has non-volatile memory that maintains all system addressing and master control programming during a power outage. After the power outage, the memory restores all system lighting to its previous state before the power failure.

Can I replace or move a dimmer after the initial installation?

Yes. One or all of the dimmers can be relocated to different locations in the home, if the user prefers to control different lights. All system addressing, as well as master control and wireless controller programming remains unchanged.

Can I add to my AuroRa system?

You can increase the capability of your AuroRa system by adding another complete package or by adding up to nine additional wireless controllers. (See "Bridging AuroRa Systems" on page 15)

Can I use two AuroRa dimmers to control a light or a group of lights?

No. AuroRa dimmers work with standard 3 or 4-way switches. Only one AuroRa dimmer can be used to control a light or group of lights.

General Information

- Caution:** To avoid overheating and possible damage to other equipment, do not use dimmers to control receptacles, fluorescent lighting fixtures, motor-operated or transformer-supplied appliances.
- Caution:** Use dimmers with 120V incandescent lighting fixtures only. Do not use with low-voltage transformers.
- Install in accordance with all national and local electrical codes.
- When there is no ground wire or way to connect the wallbox, to ground within the wallbox the NEC® 2002, Article 404-9 allows a dimmer without a grounding connection to be installed as a replacement, (as long as a plastic, noncombustible wallplate is used). For this type of installation, cap or remove the green ground wire on the dimmer, and use an appropriate wallplate (such as Lutron's Fassada® series wallplates).
- Do not paint dimmers or wallplates.
- Cleaning Instructions:** Clean with a soft, damp cloth only. Do not use any chemical cleaners.
- The total wattage of all light bulbs controlled by each dimmer must be between 50 and 600 watts.
- Dimmers work with most incandescent light bulbs. Dimmers may not work with dioded light bulbs (Sylvania Designer 16™ or Philips PAR-16™).
- Operate system in temperatures between 0°C (32°F) and 40°C (104°F).
- Dimmer may feel warm to the touch during normal operation.
- Recommended wallbox depth is 2 1/2" minimum.

12. Single-pole circuit

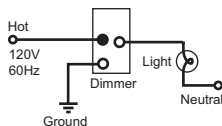

Three-way circuit

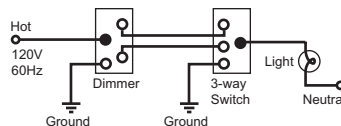

Four-way circuit

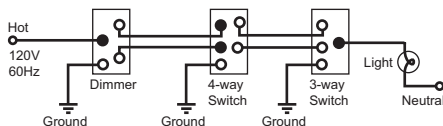

- When combining dimmers in the same wallbox, the dimmer's load capacity must be reduced.

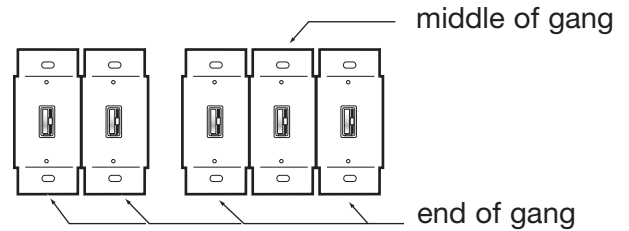

Follow the load capacities in table below for multi-ganged dimmers.

Derating Chart

Model	Not Ganged	End of Gang	Middle of Gang
AR-6D	600 W	500 W	400 W

- Wire Preparation:**

Trim or strip wallbox wires to the length indicated by the strip gauge on the back of the dimmer.

Push-in: Use #14 AWG solid copper wire only. Insert wires fully. For aluminum wire, consult an electrician. **DO NOT** use stranded or twisted wire.



Screw Terminals: Tighten securely. Screw terminals are for use with solid copper wire only. For aluminum wire, consult an electrician. **DO NOT** use stranded or twisted wire.



- Service Switch:** Pull service switch out to open position to replace light bulbs. Push service switch in after new bulb is installed.



service switch open



service switch closed

Troubleshooting

Symptom	Possible Cause	Remedy
Dimmers do not respond to the wireless controller.	Central antenna is not powered.	Ensure that plug on the rear of the central antenna is inserted fully and that the unit is plugged in to a live wall receptacle.
	The wireless controller may be out of communication range of the central antenna.	Move the wireless controller closer to the central antenna and try again. We recommend no more than 100 feet.
	Batteries in the wireless controller are weak or dead. (factory installed batteries are designed to last ten (10) years during typical useage)	Replace batteries in the wireless controller with new ones (CR2032).
Master control or central antenna appears not to be working at all.	No power available to unit.	Ensure that the plug on the rear of the unit is inserted fully and that the unit is plugged in to a live wall receptacle. Check that the receptacle is not controlled by a switch. Check that breaker is on and not tripped.
	Faulty dc adapter.	Swap dc adapters with master control or central antenna and check unit for power.
A dimmer appears not to be working at all.	Burned out or missing light bulb.	Replace light bulb.
	Service switch is in the OFF position (pulled out).	Turn service switch on by pushing the switch in. See note 15 on page 18.
	No power available to unit.	Check that breaker is on and not tripped.
Dimmer keeps turning on and off.	Unit has been wired incorrectly.	Refer to wiring instructions.
	Wattage is under recommended minimum load.	See number 7 on page 18.
	2 or more AuroRa dimmers on one circuit.	Remove and replace additional AuroRa dimmer with standard 3/4-way switch.
Dimmer performs normally when operated manually, but fails to respond to master control button pushes.	The dimmer may be out of communication range of the central antenna.	Move the central antenna closer to the dimmer.
	The master control may be out of communication range of the central antenna.	Move central antenna closer to master control.

Notes

FCC Information

NOTE: This equipment has been tested and found to comply with the limits for a Class B digital device, pursuant to part 15 of FCC rules. Operation is subject to the following:

1) This device may not cause harmful interference, and
2) This device must accept any interference received, including interference that may cause undesired operation. The user is encouraged to try to correct the interference by one or more of the following measures:

- Re-orient or relocate the receiving antenna.
- Increase the separation between the equipment and receiver.
- Connect the equipment into an outlet on a circuit different from that to which the receiver is connected.
- Consult the dealer or an experienced radio/TV technician for help.

CAUTION: Changes or modifications not expressly approved by Lutron Electronics Co. may void the user's authority to operate this equipment.

Worldwide Technical and Sales Assistance

If you have questions concerning the installation or operation of this product, call the Lutron Technical Support Center. Please provide the exact model number when calling.

USA, Canada, and the Caribbean 800.523.9466
Other countries call 610.282.3800
Fax 610.282.3090

Visit us on the web at www.lutron.com

Lutron Electronics Co., Inc.
7200 Suter Road
Coopersburg, PA 18036